

Curbs Plus, Inc.

1200 Carline Road
 Rossville, GA. 30741
 PH (706) 858-1188 / FAX (706) 866-2339

APPROVED BY: _____

DATE APPROVED: _____

CPC-1 (Insulated) Conventional Roof Curb

STANDARD FEATURES

1. 18 Ga. Prime Galvanized Steel Construction
2. Fully Welded Watertight One-piece Construction
3. Primed Painted after Fabrication
4. Pressure Treated 2 x 2 Wood Nailer
5. 1-1/2" Thick 3# Density Fiberglass Insulation
6. Internal Angle Reinforcement
7. Fully Mitered and Welded Raised 3" Cant

OPTIONS:

- 1.
- 2.
- 3.
- 4.

PROJECT NAME: _____

CITY, STATE: _____

CUSTOMER: _____

JOB NUMBER: _____

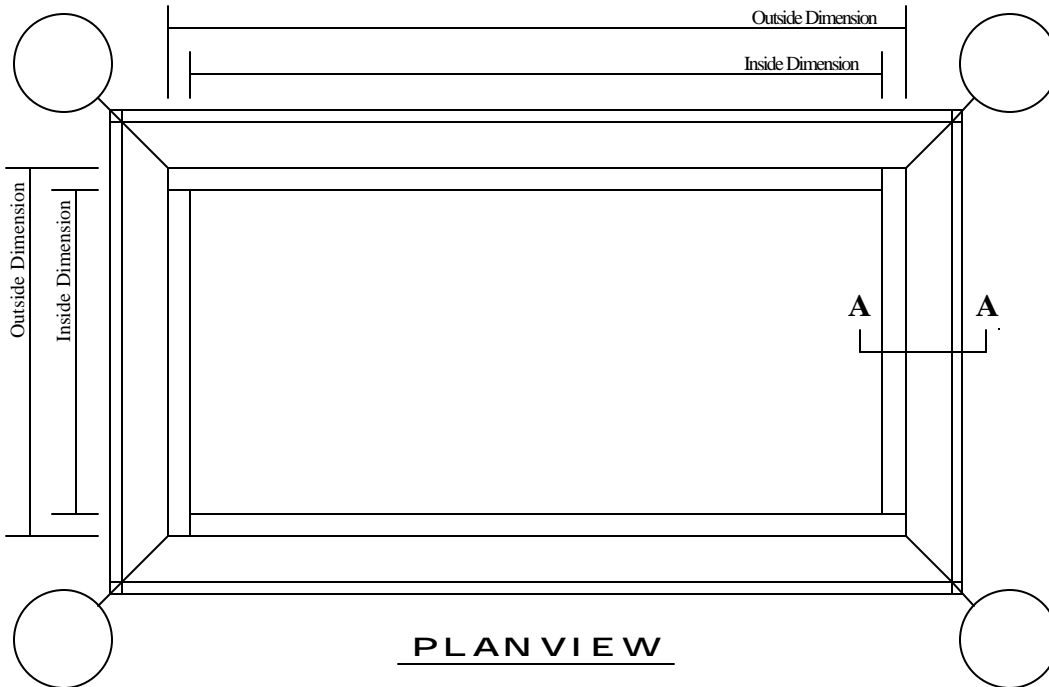

PLAN VIEW

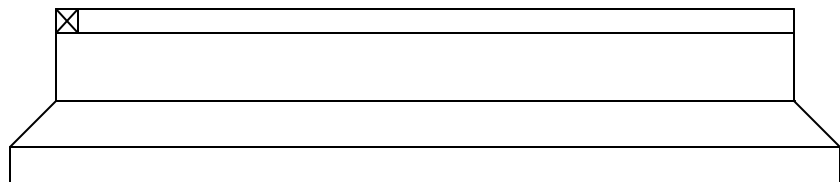

ELEVATION

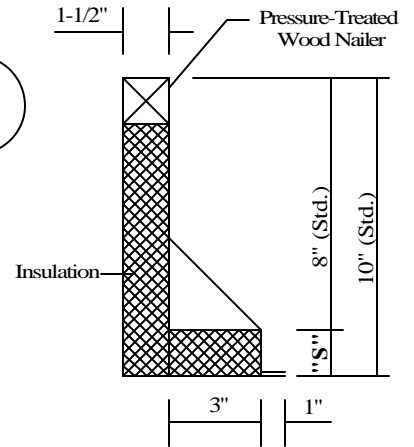

SECTION A-A

QUANTITY	INSIDE DIMENSION	OUTSIDE DIMENSION	HEIGHT	"S"	TAG